



7092 PROOF Mercury EL

Certified self-loading stretcher



FEATURES

Mercury EL is the newest entry in Me.Ber's range of ambulance cots. Sharing many features from other Mercury models, the EL is a naturally highly reliable and versatile cot. This model represents the entry level for the Mercury line.

Unlike most Mercury models, the EL does not feature a foldable front trolley nor 4 swivel castors and it's not multilevel. However, this version serves as a **perfect solution** when a high standard of quality must be met while keeping things **easy and accessible**.

Safe-Frame Technology:

The frame of an ambulance cot must withstand intense mechanical stress: this is why Mercury features a single-piece frame, in line with Me.Ber's Same Frame building philosophy.

Thanks to this expedient, the structure of the cot is extremely safe and robust through time.



Device certified according to the European harmonized safety standards UNI EN 1865 - UNI EN 1789.

*All Pictures shown are for illustration purpose only.

MAIN FEATURES

Type	
Size	Adults
Usage	Transport
10G Certification	
Wheel type	2 Rotating Wheels + 2 Big Fixed Wheels
Lying surface	With Trendelenburg
Max height (cm)	95
Max loading height (cm)	66
Min loading height (cm)	64
Folded height (cm)	31
Width (cm)	57
Length (cm)	197
Weight (kg)	40
Loading capacity (kg)	250
Material	Painted steel ABS HDPE (High-density polyethylene)

SEE ALSO



Mercury EL 7094 PROOF
Certified self-loading stretcher - high version



Mercury 7070 PROOF
Certified stainless steel variable height stretcher



Mercury 7070/4RG PROOF
Stainless steel variable height stretcher certified with 4 rotating wheels



Mercury 7072 PROOF
Certified stainless steel variable height stretcher high version



Mercury 7072/4RG PROOF
Certified stainless steel variable height stretcher high version with 4 rotating wheels



Mercury Lite 7080/4RG Proof
Ambulance cot in aluminium with variable height and four swivel castors



Mercury Lite 7082/4RG Proof
Certified aluminium variable height stretcher high version with 4 rotating wheels



Mercury Cinque 7075/4RG PROOF
Certified 5 levels self-loading stretcher with 4 swivel wheels



Mercury Cinque 7077/4RG PROOF
Certified 5 levels self-loading stretcher with 4 swivel wheels - high version



Mercury Lite Cinque 7095/4RG Proof
Certified aluminium 5 levels self-loading stretcher with 4 swivel wheels

ACCESSORIES



12025

Black multi usage object holder for automatic loading stretcher



12154

"BEAR PODS" Bariatric containment system for self-loading stretchers



12018N

Telescopic foldable phlebotomy stand for self loading stretchers



939

Instrument support for stretchers



12080

"MPB" wide bariatric platform for self-loading stretchers Frog Mercury and Gecko complete of belts with reel and fixing for stretcher



12080-001

Monting kit for bariatric platform on self loading stretcher



12070/BG

"COVER OX 2-3 BG"- professional cylinder holder for 2 and 3 lt oxygen bottles



12070/BR

COVER OX2-3 BR professional cylinder holder with belt and orange MeBer logo for 2 and 3 lt oxygen bottles



12072/BG

"COVER OX 5 BG"- professional cylinder holder for 5 lt oxygen bottles



12072/BR

"COVER OX 5 BR"- professional cylinder holder for 5 lt oxygen bottles



955 PROOF

EN 1789 fixing system for Proof roll-in stretchers



12106

Mattress for AIR-COM stretchers - Anti-bedsore mattress with alternate segments



7013/A

3 pcs. Skay fire-proof electrowelded mattress



7013/N

3 pcs. Skay fire-proof electrowelded mattress



938

Oximeb oxygen cylinder holder



608/A-MEB

2 pieces orange belt with metallic hook and MeBer band (L. 155 cm)



608/N-MEB

2 pieces black belt with metallic hook and MeBer band (L. 155 cm)



612/AN-2/MEB

Adjustable thoracic abdominal belt



612/N-2/MEB

Adjustable thoracic abdominal belt

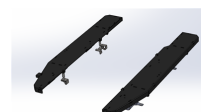

12200

Bariatric wings set for Mercury self-loading stretchers complete with mattresses, belts with reel and assembly kit

orange/black with MeBer band and
4 points fastening for self loading
stretchers and sedan chairs

black with MeBer band with 4
points fastening for self loading
stretchers and sedan chairs



707

Red 6-handle fireproof cover with
Me.Ber tape for self-loading
stretcher

STANDARD ACCESSORIES



608/N-MEB

2 pieces black belt with metallic
hook and MeBer band (L. 155 cm)



7013/N

3 pcs. Skay fire-proof electrowelded
mattress



612/N-2/MEB

Adjustable thoracic abdominal belt
black with MeBer band with 4
points fastening for self loading
stretchers and sedan chairs